



INSTRUCTIONS FOR USE

CH180-230V

TOUCH-SCREEN PROGRAMMABLE THERMOSTAT



Fantini Cosmi S.p.a. Via dell'Osio, 6 20049 Caleppio di Settala MI - ITALY
Tel. 02 956821 | Fax 02 95307006 | info@fantinicosmi.it | <http://www.fantinicosmi.it>
Technical support: supportotecnico@fantinicosmi.it
EXPORT DEPARTMENT Tel. ++39 02 95682222 | export@fantinicosmi.it

Thank you for purchasing a **FANTINI COSMI S.p.A.** product.

Read this instructions manual carefully and always keep it handy for any consultation.

The documentation reflects the characteristics of the product. However, due to regulatory or commercial changes, customers are advised to check the availability of updates to this documentation on the website at FANTINI COSMI S.p.A.: pdf.fantinicosmi.it

OPERATION

The CH180-230V is a programmable thermostat for controlling heating and/or cooling systems.

It has a customised temperature program on a time profile for every season, which can be changed as needed.

The positive LCD display with white backlighting can also show an intuitive graph of the energy consumption of the entire system.

CONTENTS OF PACKAGE

- 1 programmable thermostat
- 2 6/32UNC American standard thread screws to secure onto 503 flush mounting box (approximately Ø 3.5mm)
- 1 quick guide

DESCRIPTION OF DISPLAY KEYS

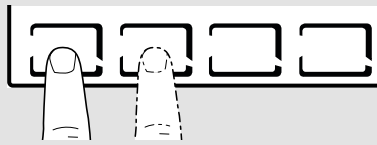

The first press of any touch button allows you to activate the functions of the buttons themselves and to light up the display.

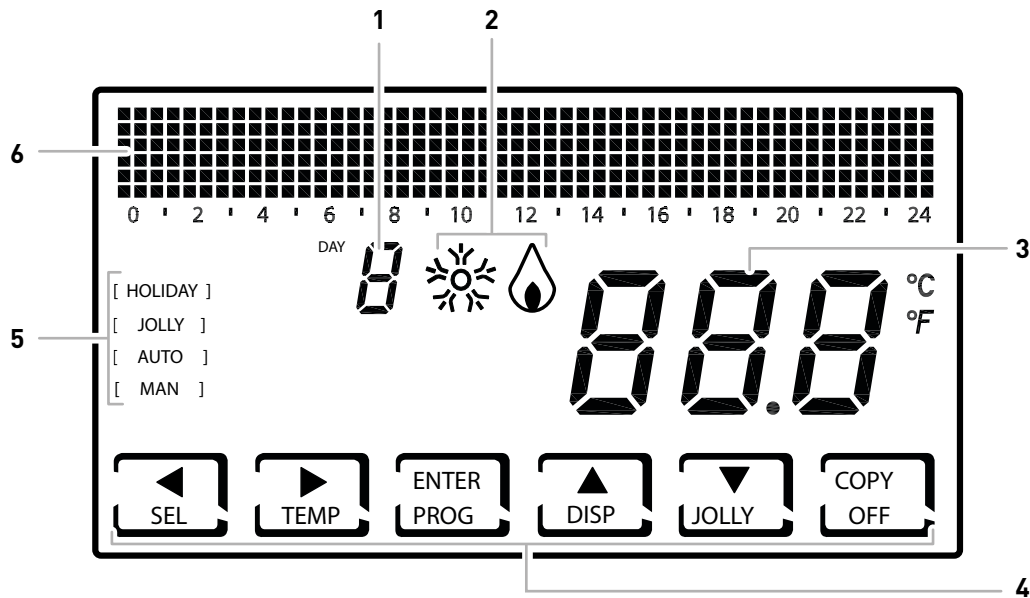

- | | |
|---|------------------------------------------------------|
| 1 | Day of the week |
| 2 | Activation status: air conditioning or heating |
| 3 | Measured room temperature (Celsius/Fahrenheit) |
| 4 | Multi-function touch icons |
| 5 | Operating mode |
| 6 | Bar graph for viewing messages and daily programming |

The function of the multi-function keys varies depending on the situation and is described by the symbol which appears on the display near the key itself.

TECHNICAL FEATURES

Temperature adjustment scale	2 - 40°C, increase 0.1°C
Measurement scale/room T display	- 50 - + 50 °C
Power supply	230V 50 Hz
Type of output	1 relay with potential-free change-over contact (COM/NA/NC) 3 screw terminals (closed + open)
Relay contact range	5(3)A 250 Vca
Type of action	1 B.U. (micro connection)
Software	class A
Minimum adjusting differential	STD- 0.3 - 5 K
Reference thermal gradient	4 K/h
Maximum room temperature	45°C
Storage temperature	-10°C - +60°C
Electric insulation	Double insulation
Protection rating	IP40
Pollution rating	2
Pulse voltage	4000V
Assembly	wall-mounted or on flush mounting box
Dimensions	127 x 82 x 24 mm
Compliant with standards	EN 60730-1 and second parts
ErP classification	■ ErP Class IV; 2% [Reg. EU 811/2013 - 813/2013]
Compliant with Directive	Directive 2014/53/EU (RED)
Product made in Italy	

Summary

OPERATION	2	6.9 - CHG	25
CONTENTS OF PACKAGE.....	2	6.10 - TECHNICAL.....	25
DESCRIPTION OF DISPLAY KEYS	3	6.11 - RESETTING DEFAULT PARAMETERS.....	26
TECHNICAL FEATURES	4	7 - DISPOSAL.....	27
1 - INSTALLATION	6	8 - GENERAL WARRANTY CONDITIONS	27
2 - ELECTRICAL CONNECTION.....	8		
3 - QUICK PROGRAMMING GUIDE (PROG).....	9		
3.1 - DATE AND TIME SETTING	9		
3.2 - WINTER/SUMMER SETTING	10		
3.3 - HOURLY PROGRAMMING SETTING (PROFILE).....	10		
3.4 - SETTING THE DISPLAY.....	12		
3.5 - SETTING KEYBOARD LOCK WITH PASSWORD	13		
4 - OPERATION (SEL).....	14		
4.1 - OPERATING PROGRAMS	14		
4.2 - SELECTING THE OPERATING PROGRAM.....	15		
4.3 - "JOLLY" PROGRAM SETTING.....	16		
4.4 - SETTING "AUTO" and "HOLIDAY" PROGRAM TEMPERATURE.....	17		
4.5 - SETTING "MANUAL" and "JOLLY" PROGRAM TEMPERATURE ...	17		
5 - PARAMETER DISPLAY (DISP)	18		
5.1 - DATE AND TIME.....	18		
5.2 - SEASON	18		
5.3 - PROFILE.....	19		
5.4 - HOURS OF USE.....	20		
6 - ADVANCED FUNCTIONS (PROG)	21		
6.1 - SECONDS DISPLAY STAYS ON	21		
6.2 - DISPLAY INTENSITY	21		
6.3 - DAYLIGHT SAVINGS TIME.....	22		
6.4 - ANTIFREEZE TEMPERATURE	22		
6.5 - ROOM TEMPERATURE CORRECTION	23		
6.6 - DIFFERENTIAL MANAGEMENT.....	23		
6.7 - CELSIUS / FAHRENHEIT	24		
6.8 - LANGUAGE	24		

1 - INSTALLATION

**ATTENTION!**

Installation must be carried out by qualified personnel in compliance with the requirements concerning the installation of electrical devices.

**ATTENTION!**

Make sure that the power supply is disconnected before performing installation.

The CH180-230V programmable thermostat must be installed on the wall or on a flush mounting box, in 3 units or round, at a height of about 1.5m from the floor, in a suitable position to detect the room temperature correctly.

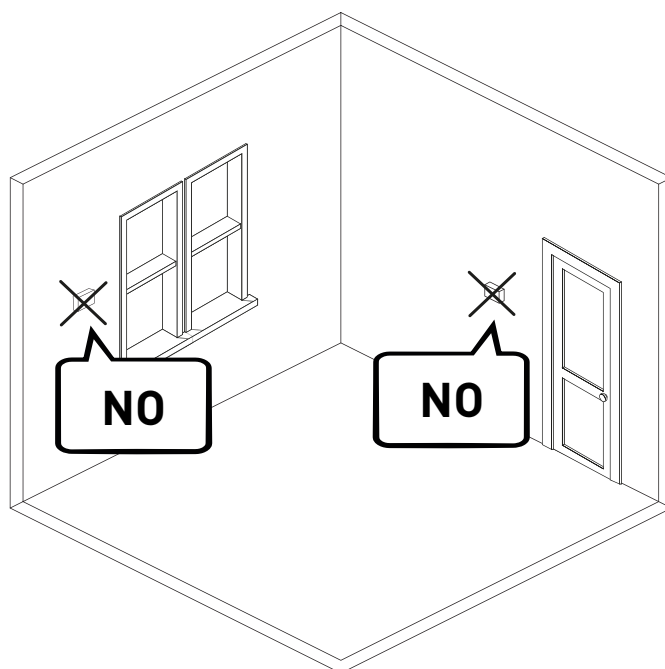
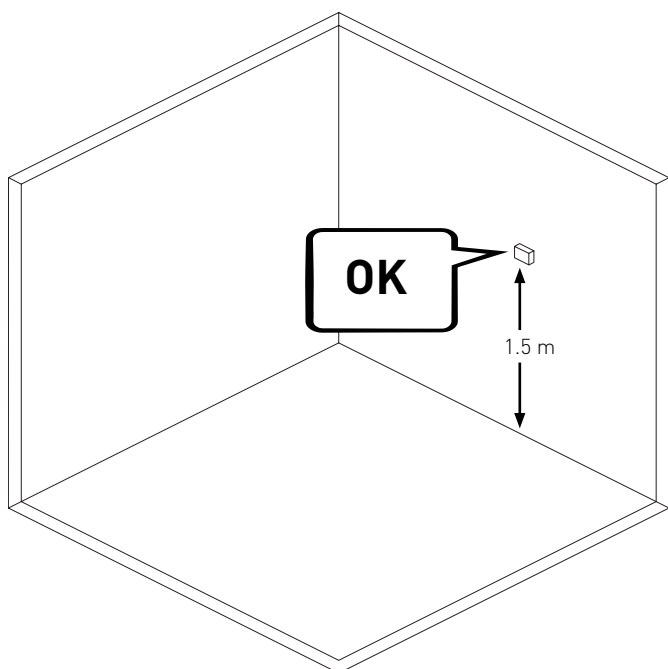
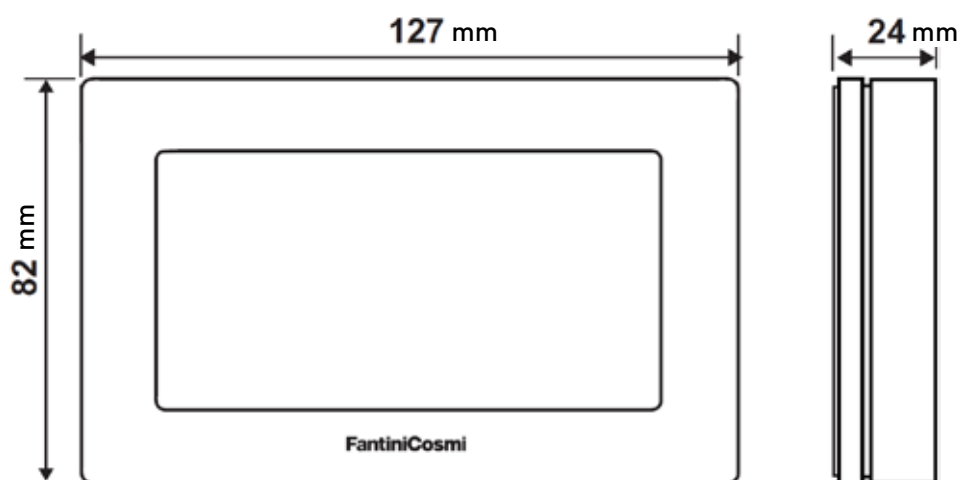

Pry the back panel off the body by applying pressure to the specific groove at the bottom.

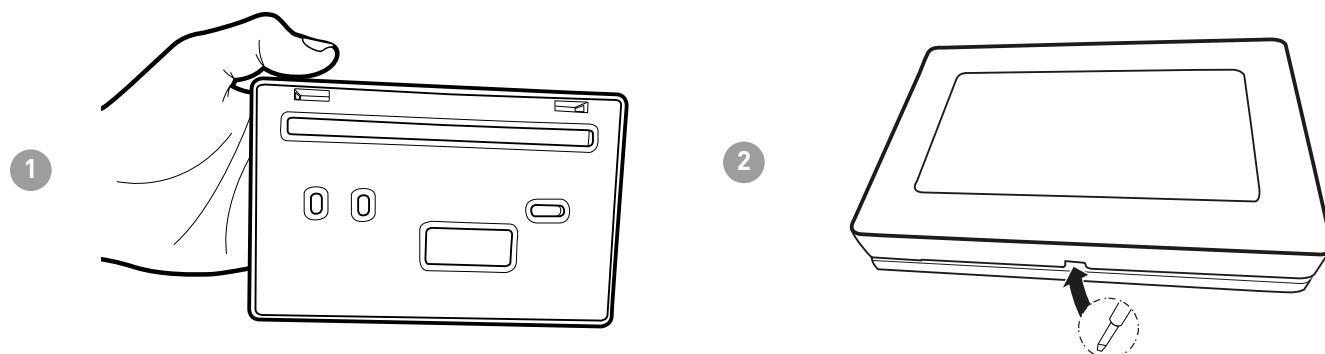

Remove the insulating protection by unscrewing the specific waterproof screw.

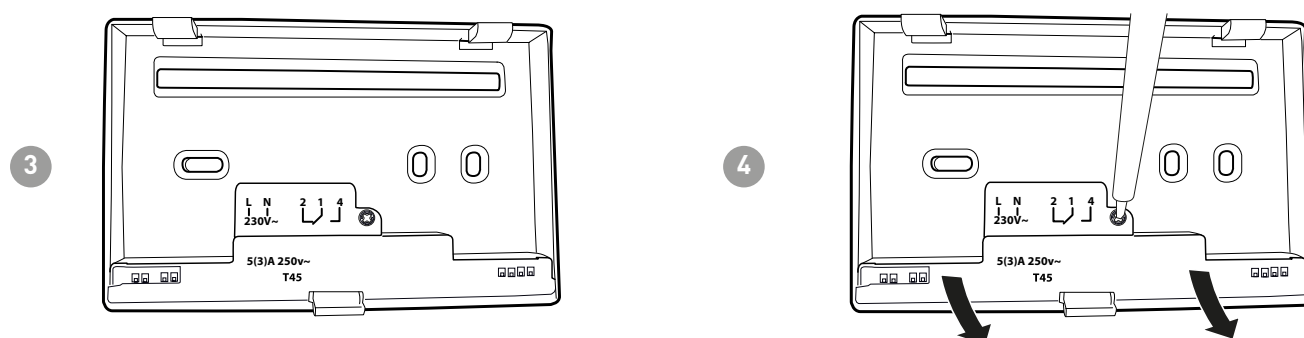

Make the electrical connections (refer to the "Electrical connections" paragraph) and secure the panel to the wall with the supplied screws.

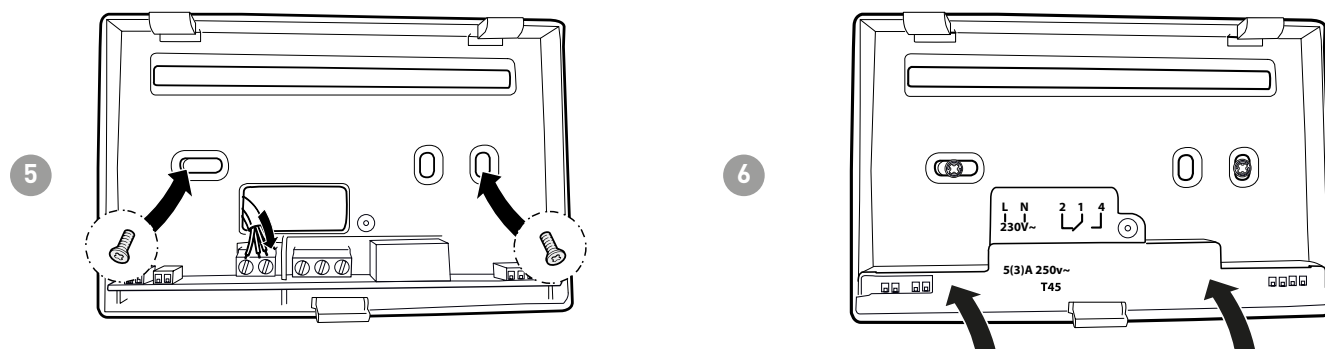

Tighten the screw shown and hook the body onto the panel on the wall.

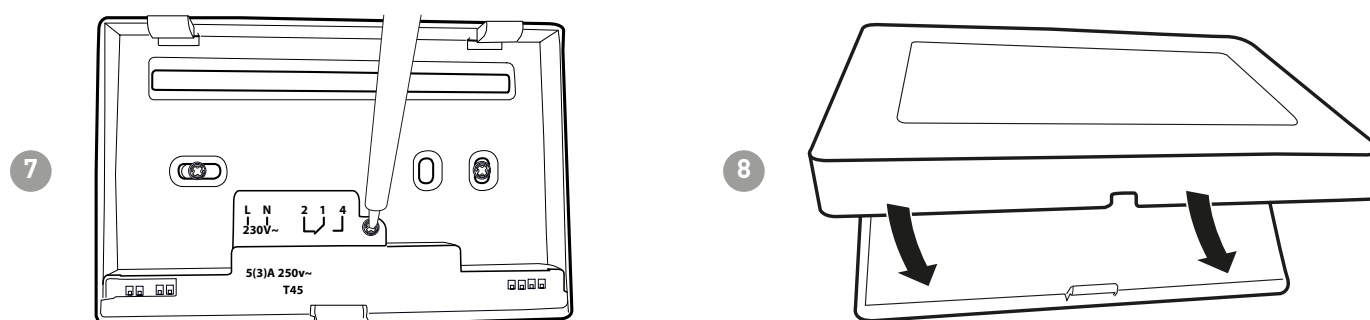

2 - ELECTRICAL CONNECTION

**ATTENTION!**

Electrical connections must be made by qualified personnel.

**ATTENTION!**

Electrical connection operations must be done with the system's power disconnected.

Electrical connections must be made referencing the following diagram.

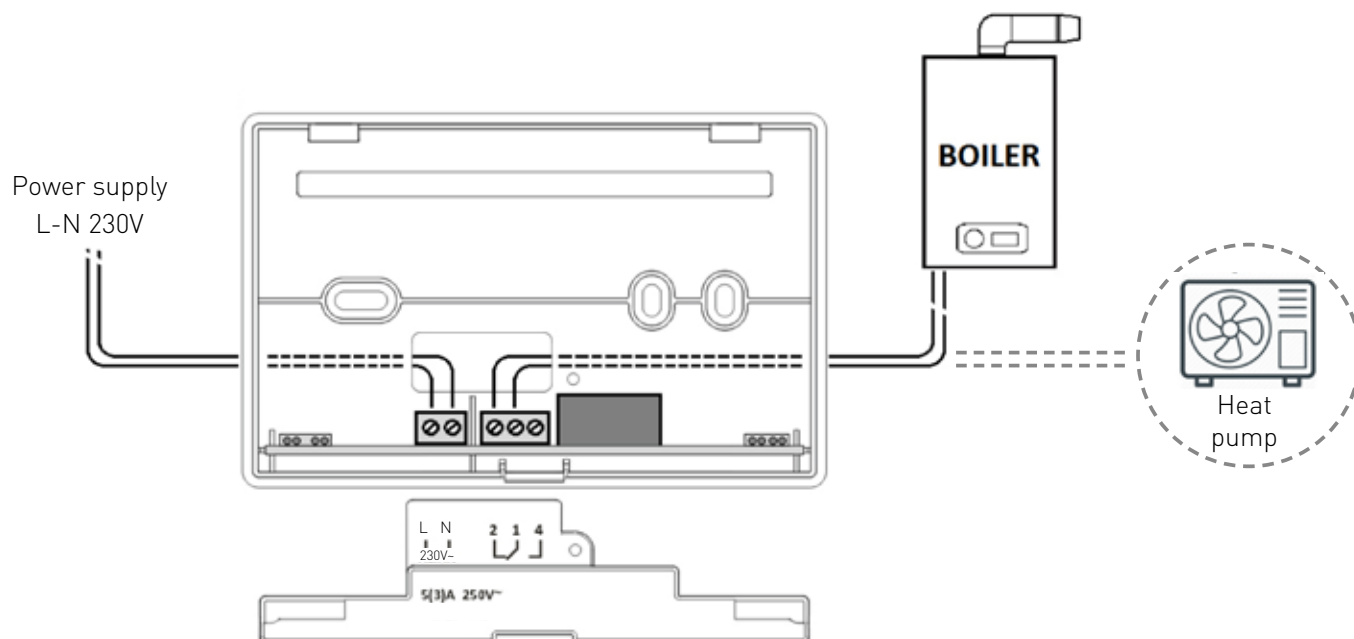

3 - QUICK PROGRAMMING GUIDE (PROG)

The first time any touch key is pressed has no effect, but only activates the functions of the buttons themselves and lights up the display.

After 60 seconds of no interaction, the display goes back to the main screen.

 = allows you to CONFIRM

 = allows you to PROGRAM

3.1 - DATE AND TIME SETTING

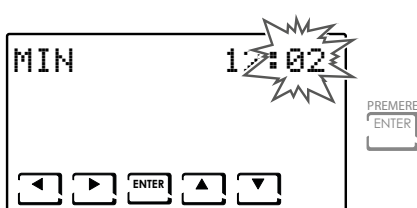
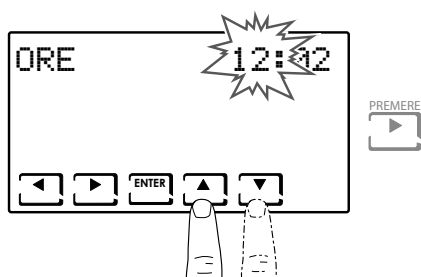
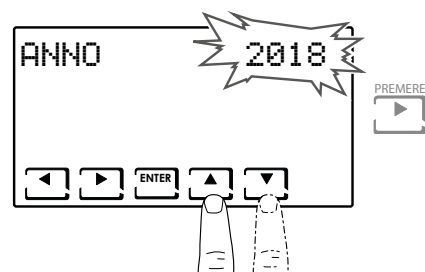
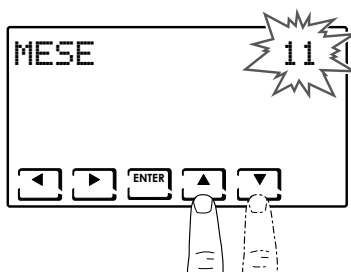

Note: pressing ◀ always allows you to go back to the previous page.

3.2 - WINTER/SUMMER SETTING

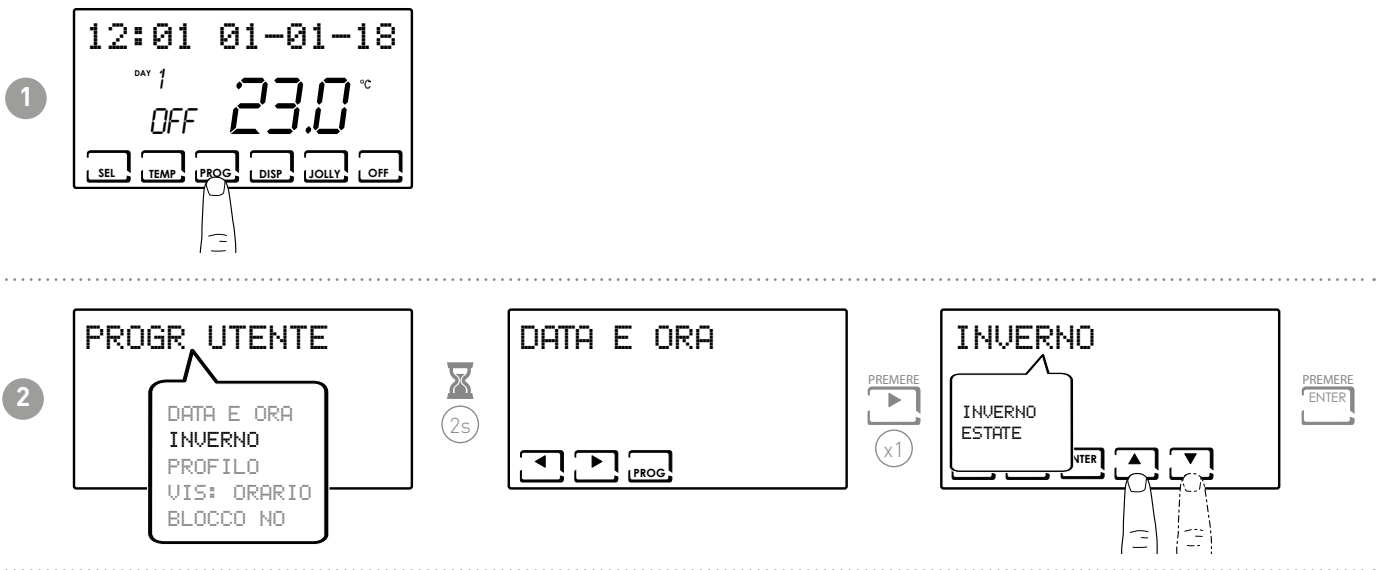

3.3 - HOURLY PROGRAMMING SETTING (PROFILE)

The profiles are set based on whether WINTER or SUMMER mode was previously selected.

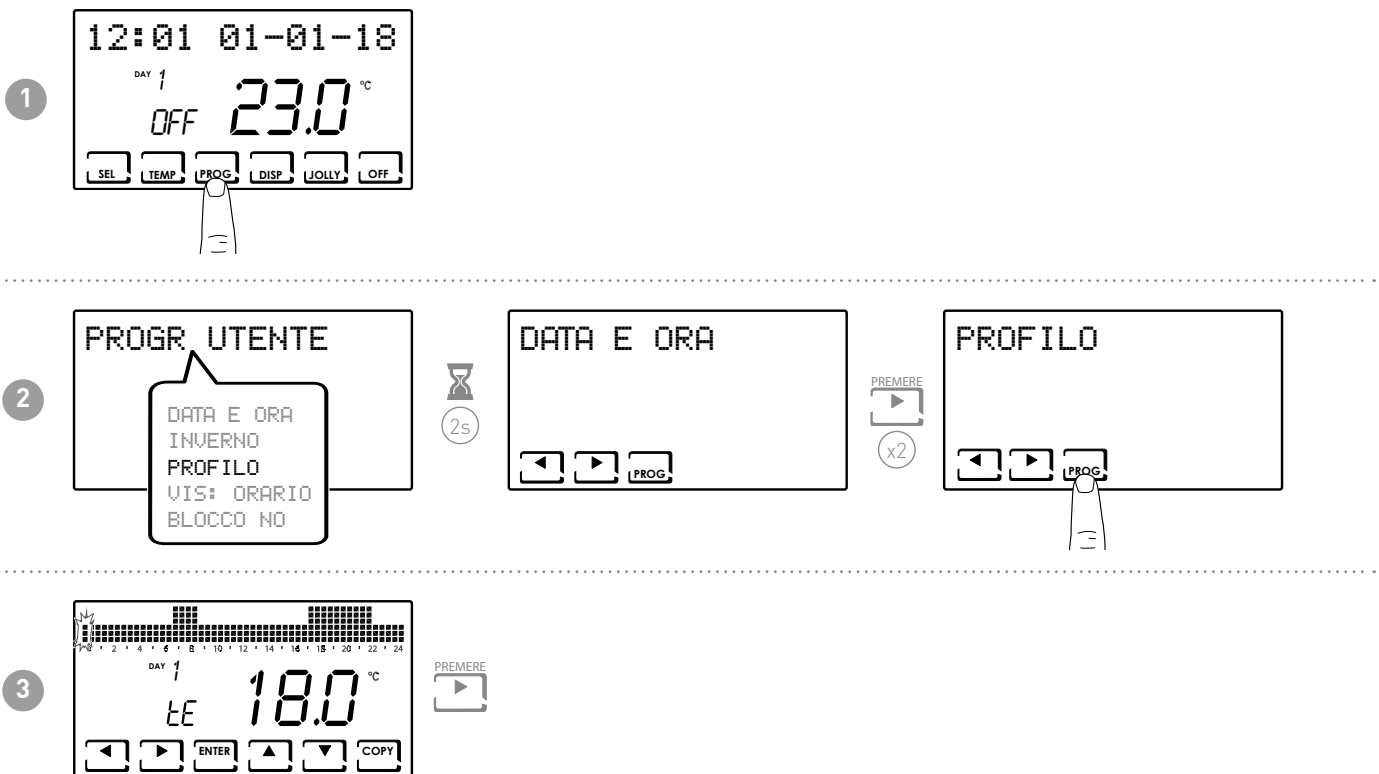

Note: pressing ◀ or ▶ allows you to move within the hours.

4

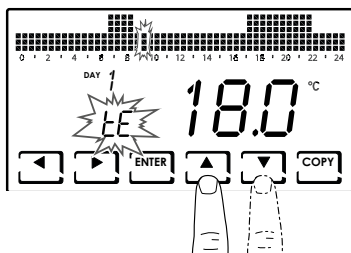

Pressing ▲ or ▼ allows you to select the profile depending on the time.

SETTABLE PROFILES:

- tC (comfort) = SUMMER, WINTER
- tE (economy) = SUMMER, WINTER
- tA (antifreeze) = only for WINTER
- OFF = only for SUMMER

In winter tE < tC; in summer tC < tE.

Note:

- Pressing ENTER allows you to go to the next day.

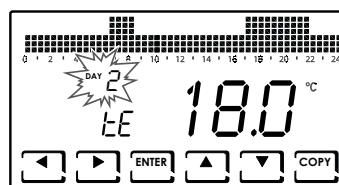
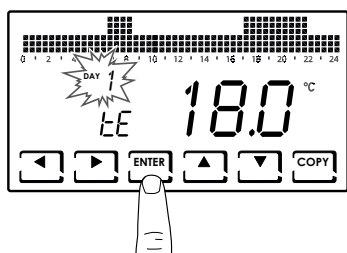

- Pressing COPY allows you to copy the temperature profile being displayed to the following day.

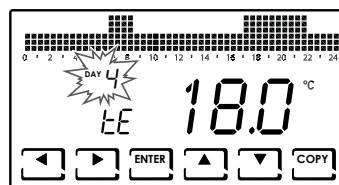
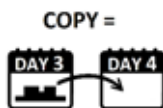
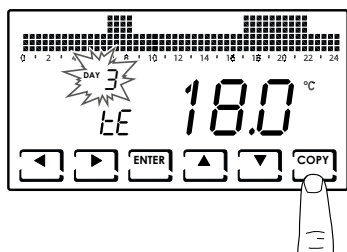

- When you reach DAY H (HOLIDAY), pressing ENTER allows you to exit the sub-function.

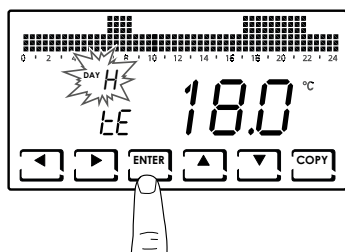

3.4 - SETTING THE DISPLAY

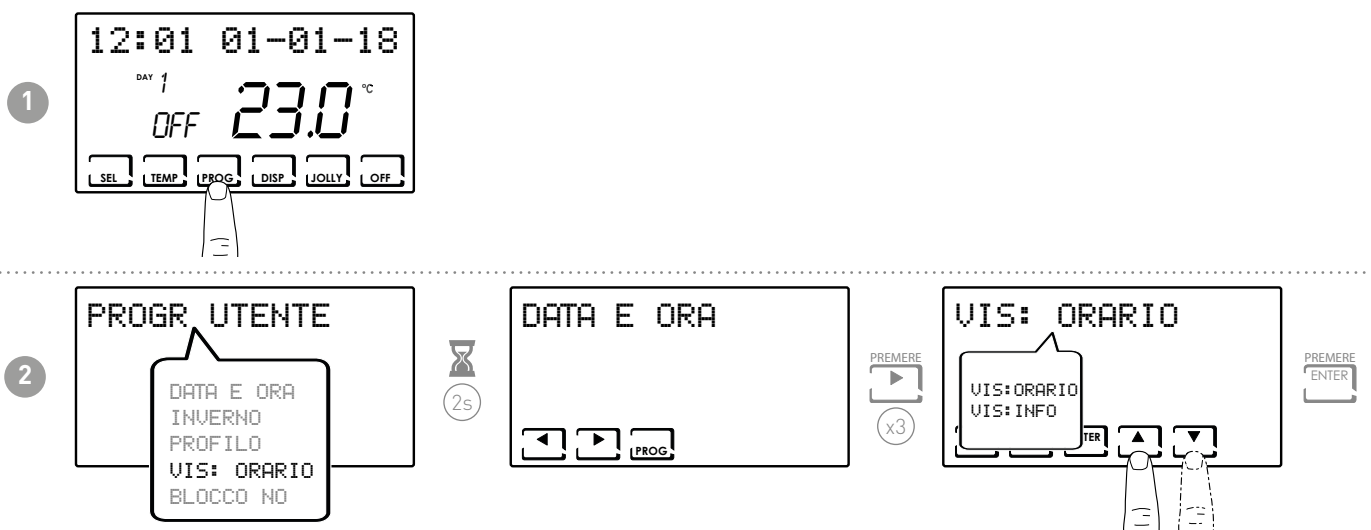

DISPLAYS:

- DISP: HOUR = displays the time on the main bar.

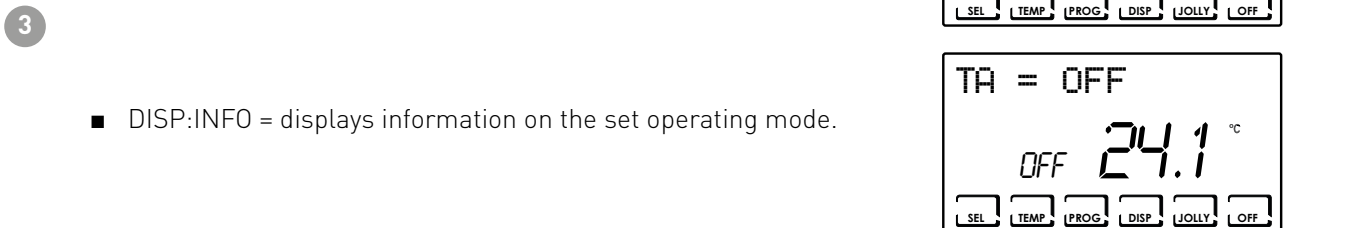

3.5 - SETTING KEYBOARD LOCK WITH PASSWORD

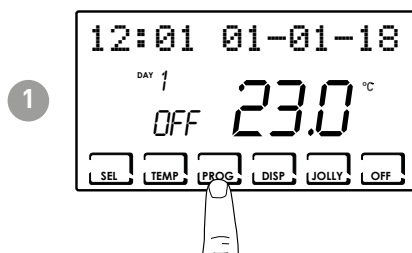

Note: selecting LOCK YES displays the PROG key. Then follow the procedure described in points 3 and 4.

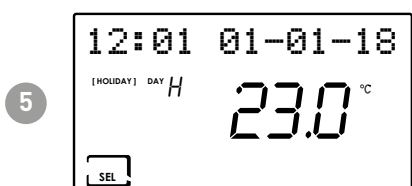
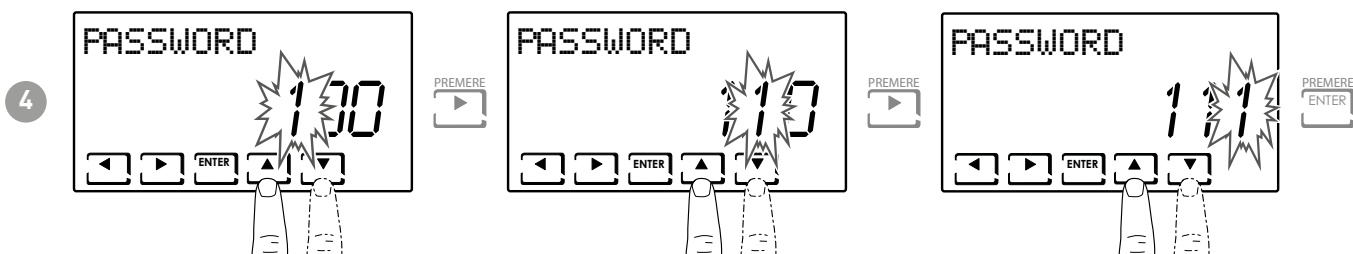
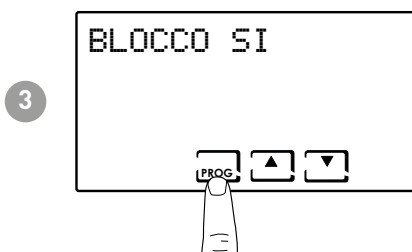

When the keyboard is locked, you can only press the SEL key.
Pressing SEL allows you to enter the set password and unlock the keyboard.

4 - OPERATION (SEL)

The CH180-230V programmable thermostat is a device equipped with a temperature sensor, with an output relay on board, which manages heating and/or air conditioning units.

The LCD display shows you how much energy the entire system consumes through an intuitive graph.

4.1 - OPERATING PROGRAMS

The programmable thermostat CH180WIFI has various operating modes called programs to manage heating/air conditioning.

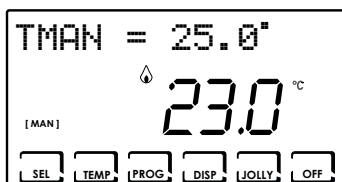

[MAN]

■ MANUAL PROGRAM

The device regulates room temperature using a set temperature specified on a case-by-case basis, for an unlimited amount of time until another program is selected.

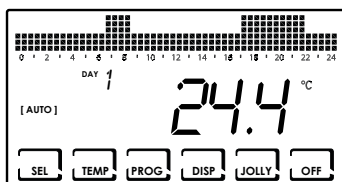

[AUTO]

■ WEEKLY PROGRAM

The device manages the temperatures set based on the hourly programs on a weekly profile. You can set the following temperature levels: tC, tE, tA/ OFF (every half hour).

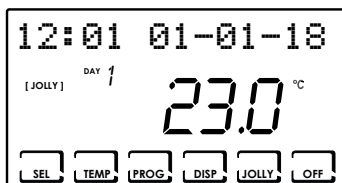

[JOLLY]

■ TEMPORARY PROGRAM

The device manages the system using a temperature that can be set over a variable amount of time (you set the hour and the day up to when you wish to keep the set temperature).

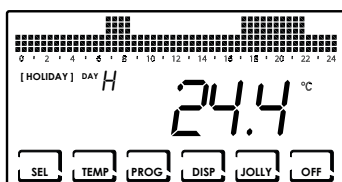

[HOLIDAY]

■ HOLIDAY PROGRAM

The device manages the system through an extra daily profile (in the event you stay home for a holiday). You can set two temperature levels: tC, tE, tA, OFF (every half hour).

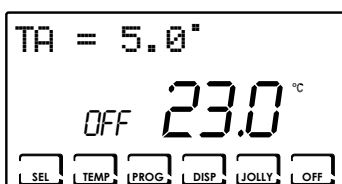

■ SYSTEM OFF or ANTIFREEZE PROGRAM

Press the OFF key to switch off the system. During WINTER mode, it maintains the antifreeze temperature.

If you press the OFF key again in SYSTEM OFF mode, it goes back to the previously set operating mode.

4.2 - SELECTING THE OPERATING PROGRAM

The programs are selected in cyclical order.

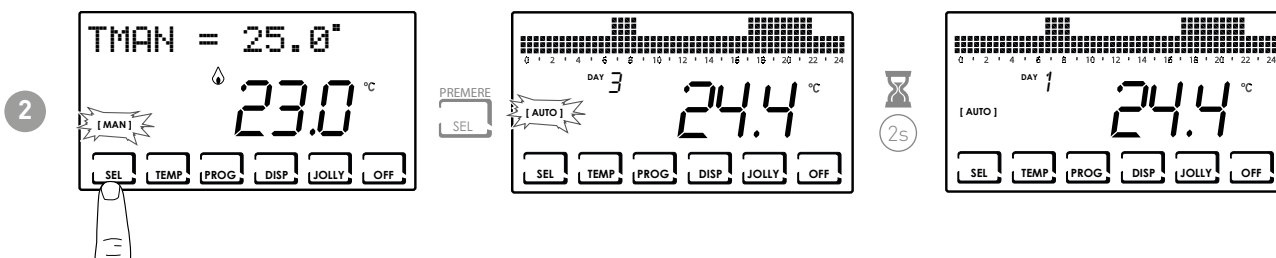
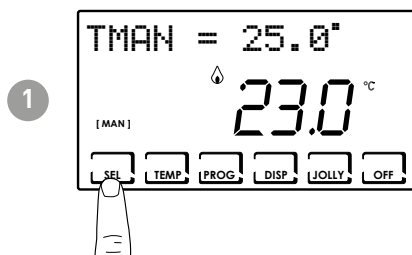

Note: you can select the program from: [MAN] - [AUTO] - [JOLLY] - [HOLIDAY].



Pressing the DISP key allows you to display certain parameters set according to the active operating program.

4.3 - "JOLLY" PROGRAM SETTING

Select JOLLY mode by following the procedure described in the "SELECTING THE OPERATING PROGRAM" paragraph or by pressing JOLLY.

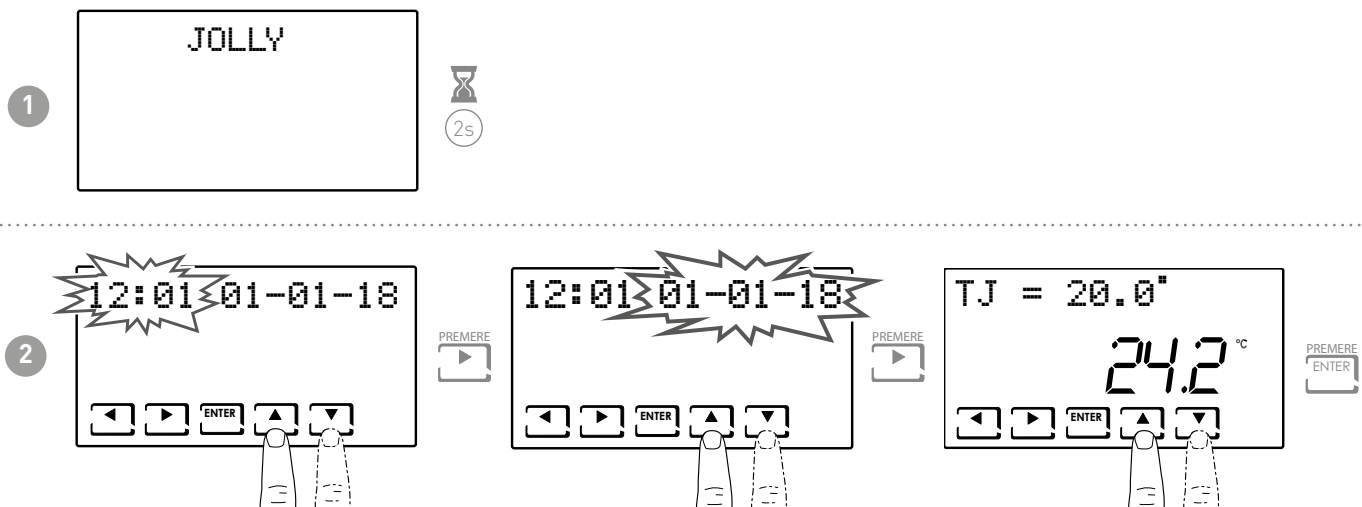

Set the time and day until you which you want to maintain the set temperature.

At the end of JOLLY mode, the programmable thermostat will return to the previously set operating status.

4.4 - SETTING “AUTO” and “HOLIDAY” PROGRAM TEMPERATURE

You can set a tCOMF (comfort temperature) and tECO (economy temperature) temperature value between 2° and 40°C.

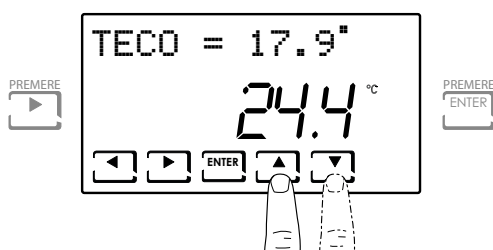
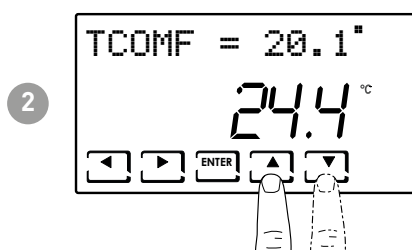
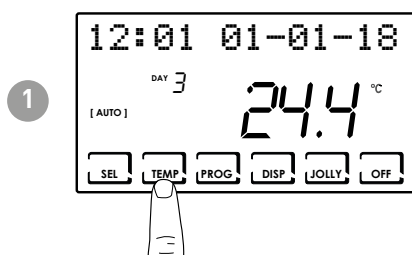

4.5 - SETTING “MANUAL” and “JOLLY” PROGRAM TEMPERATURE

You can set a TMAN and TJ temperature value between 2° and 40°C

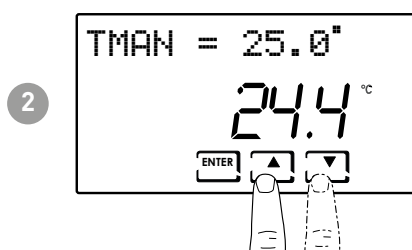
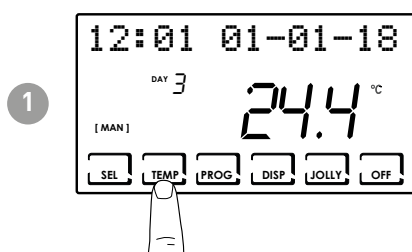

5 - PARAMETER DISPLAY (DISP)

Press the DISP key to view the most significant parameters cyclically.

5.1 - DATE AND TIME

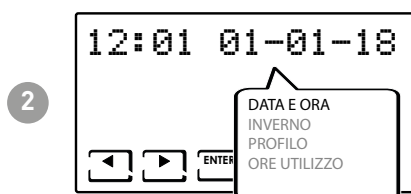
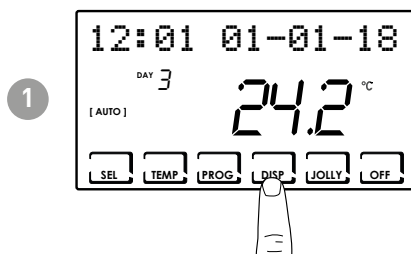

5.2 - SEASON

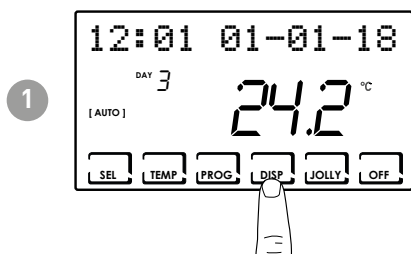

5.3 - PROFILE

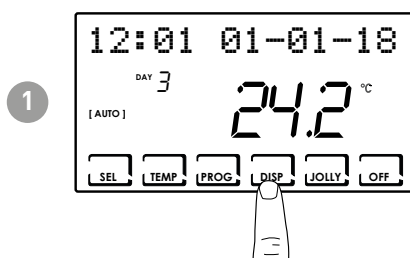

Note: this section is only visible in [AUTO] and [HOLIDAY] mode; in [JOLLY], the display shows the end date and time of the mode.

5.4 - HOURS OF USE

The programmable thermostat records the total consumption of the heating and cooling hours.

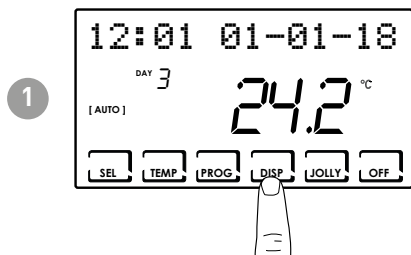

Note: it is possible to vary the use statistics by

- PREVIOUS DAY = total operating hours in the previous day
- CURRENT MONTH = total operating hours in the current month
- PREVIOUS MONTH = total operating hours in the previous month
- CURRENT YEAR = total operating hours in the current year
- TMAX = maximum room temperature measured the previous day
- TMIN = minimum room temperature measured from the previous day
- RESET

Pressing DISP on the CURRENT MONTH, PREVIOUS MONTH, and CURRENT YEAR screens displays a graph with details on use (shown below).

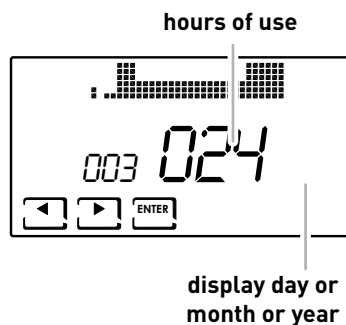

Press ◀ or ▶ to move and view the day of the month (or month or year, depending on the page displayed) and hours of use.

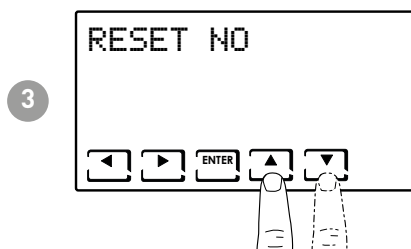

Note: select RESET YES to reset the use statistics.

6 - ADVANCED FUNCTIONS (PROG)

To access ADVANCED PROGRAMMING, hold down the PROG key for a few seconds.

6.1 - SECONDS DISPLAY STAYS ON

Allows you to adjust the display's backlight (sky blue light) with a duration that can be programmed between 5 and 30 seconds.

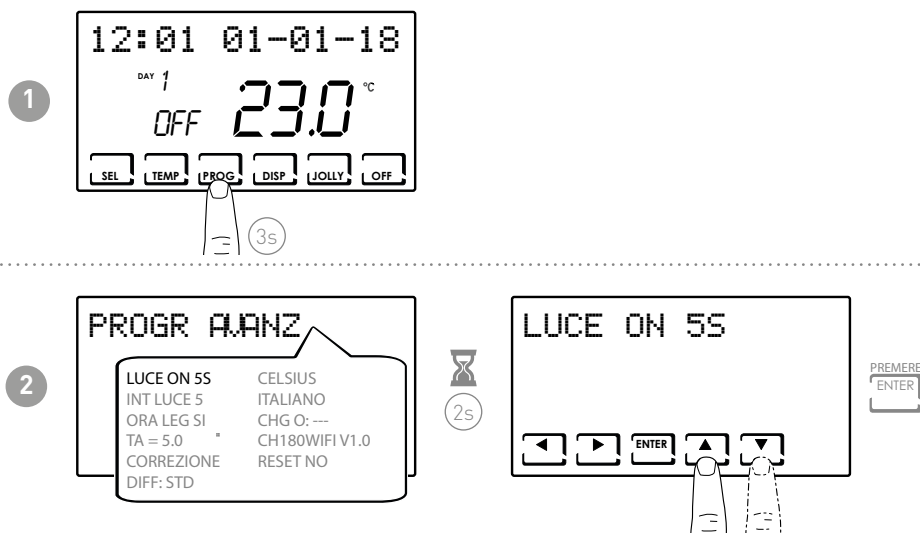

6.2 - DISPLAY INTENSITY

Allows you to modify the luminous intensity of the display, at 10 levels + 0 Off.

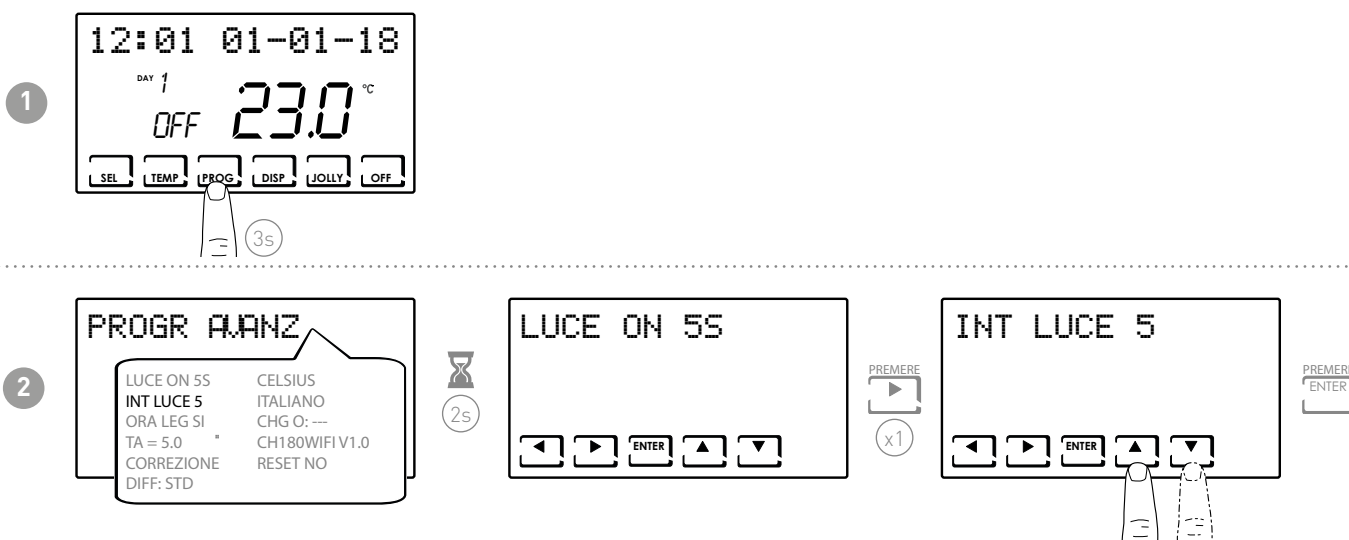

6.3 - DAYLIGHT SAVINGS TIME

Automatically selects the daylight saving time, applicable in European and some other countries. This allows you to automatically update the time at the time change (March and October) (default = YES).

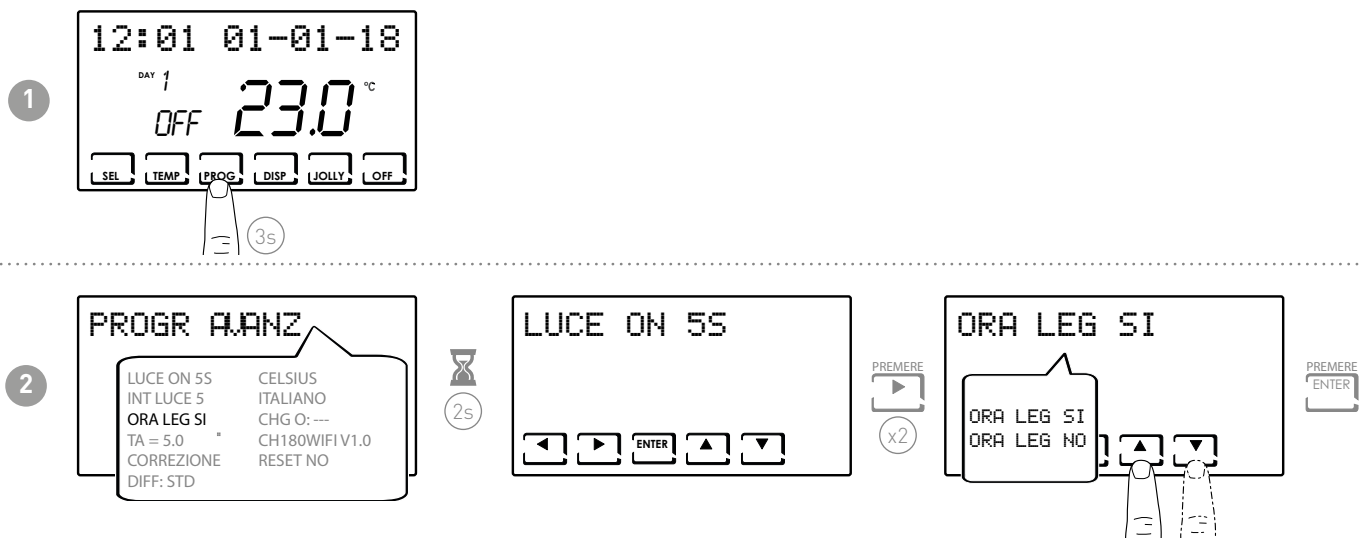

6.4 - ANTIFREEZE TEMPERATURE

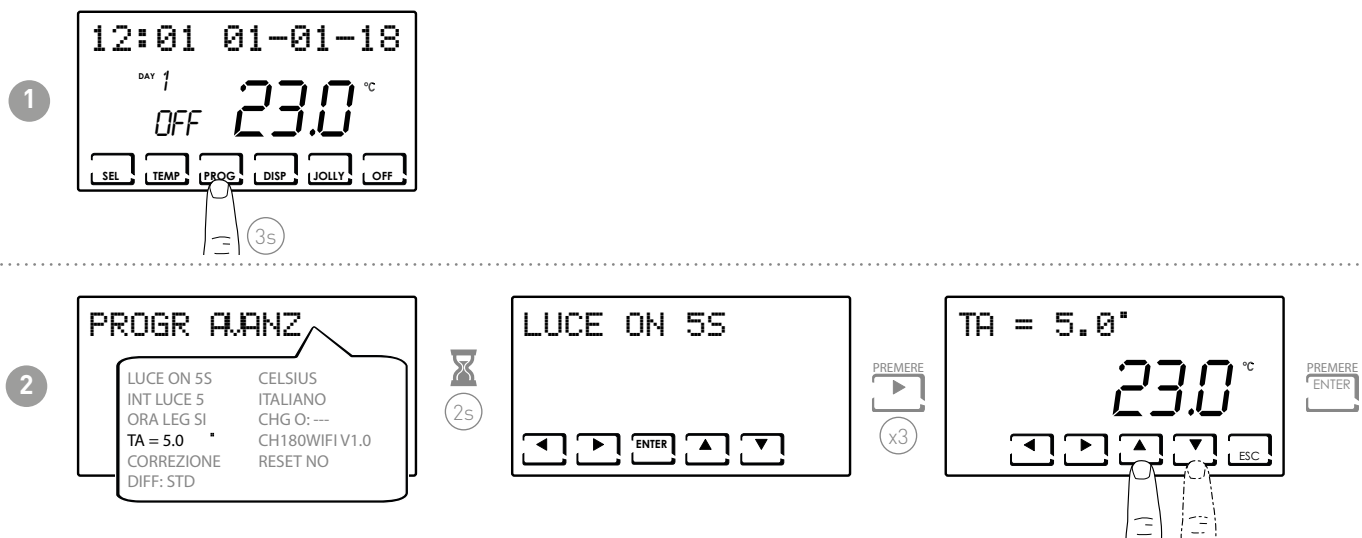

Note:

- the tA that can be set is between 2.0 and 7.0°C or OFF.

6.5 - ROOM TEMPERATURE CORRECTION

This allows you to modify the read temperature, which, due to the recessed wall installation or perhaps a non-ideal height, might not indicate the true temperature perceived.

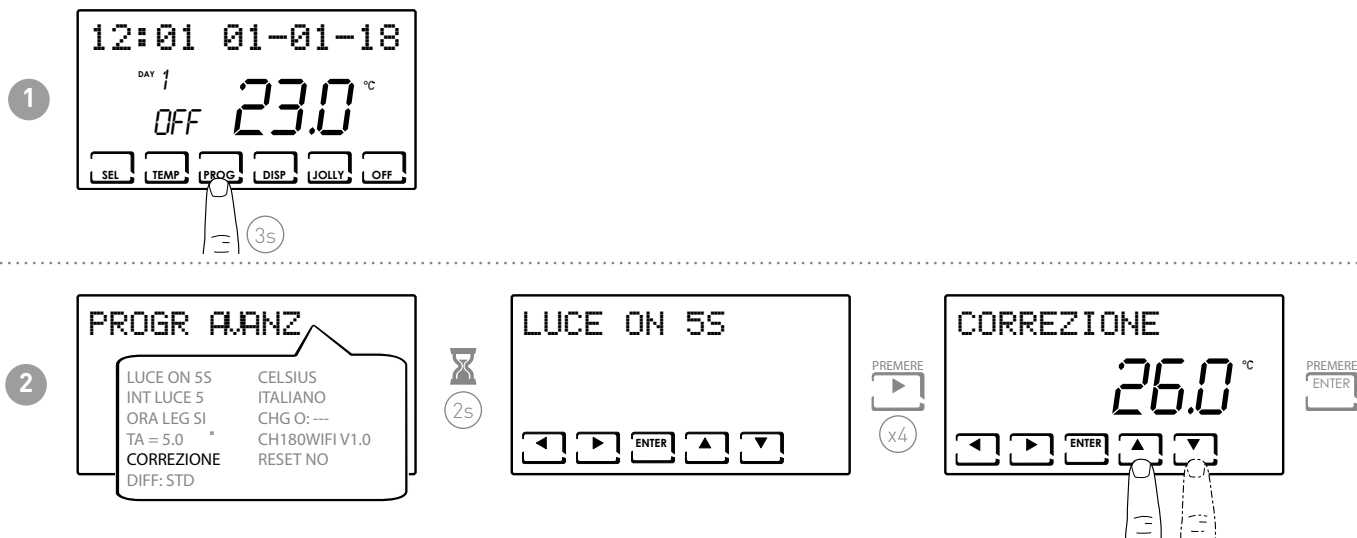

Note:

- the tA that can be set is between -5.0 and +5.0°C or OFF.

6.6 - DIFFERENTIAL MANAGEMENT

It allows the temperature difference between the OFF and ON status to be managed.

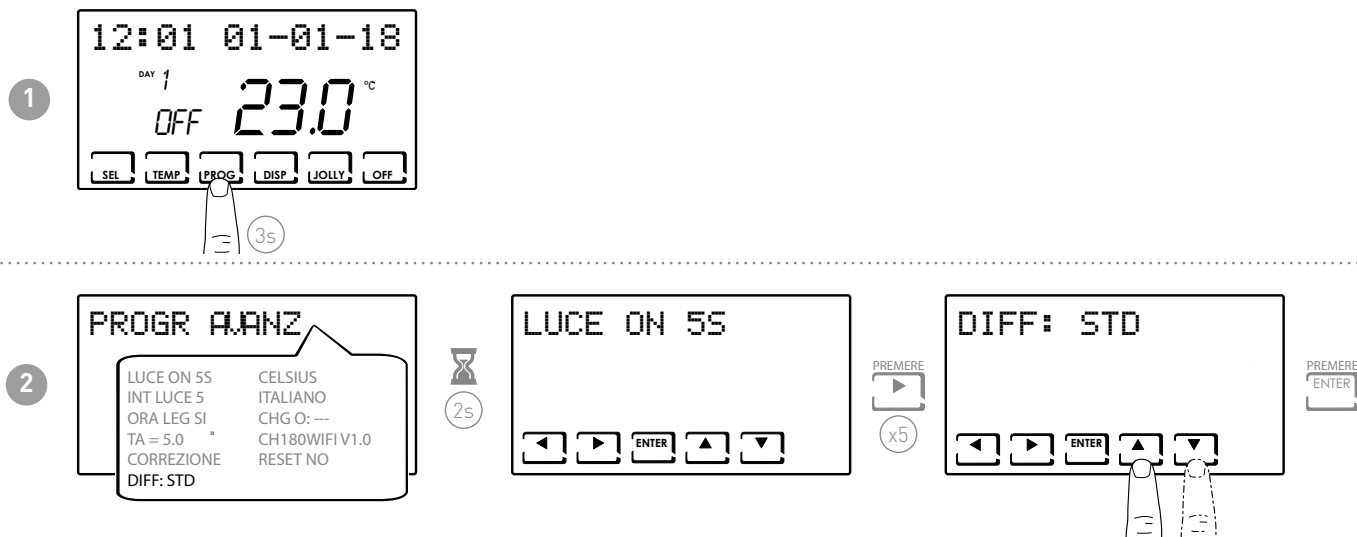

Note: the differential value that can be set is between 0.3 and 5.0, or STD (default = STD).

6.7 - CELSIUS / FAHRENHEIT

Allows you to choose the set the temperature display scale between degrees Celsius and degrees Fahrenheit.

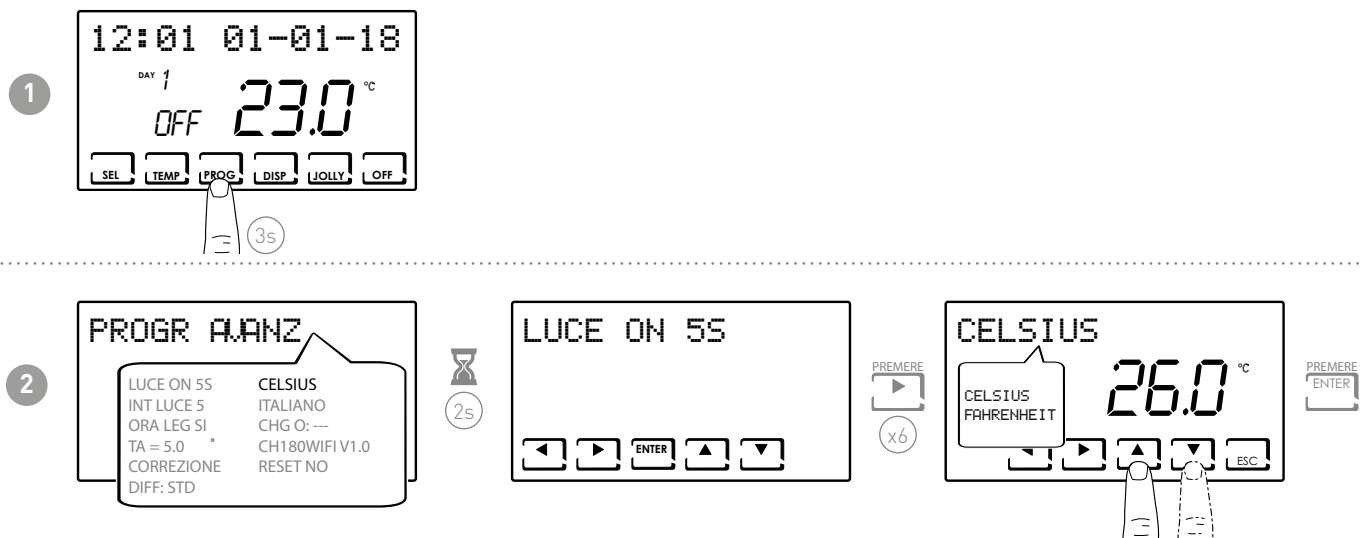

Note: the default setting is Celsius.

6.8 - LANGUAGE

Allows you to choose which language to use during programming.

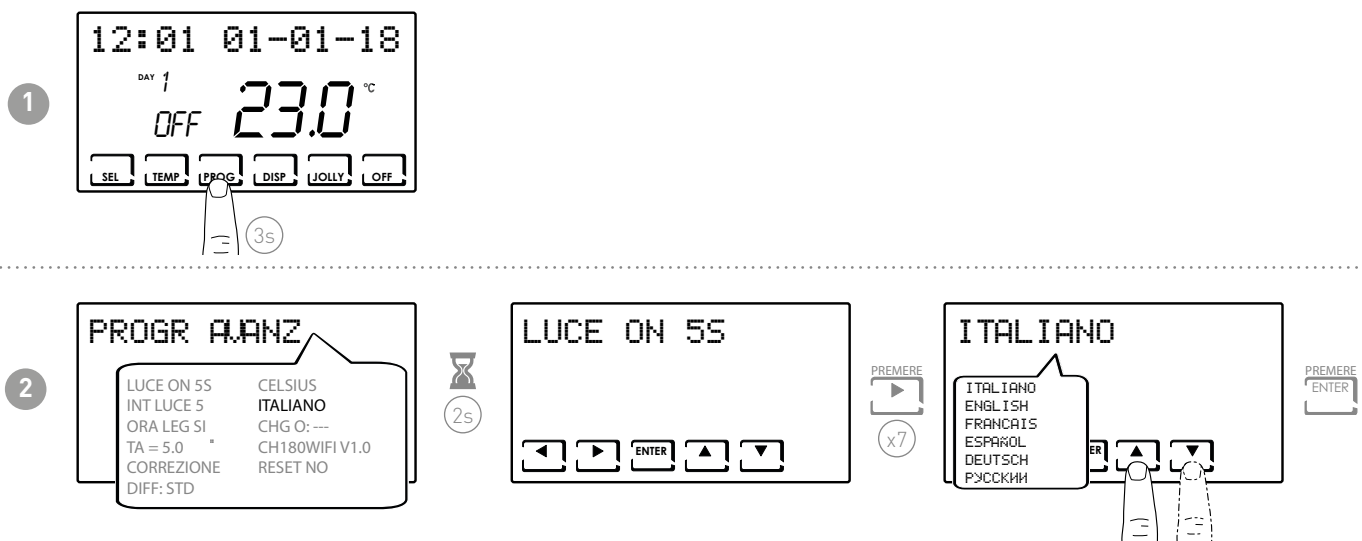

Note: the default setting is Italian.

6.9 - CHG

It allows the automatic change of seasons.

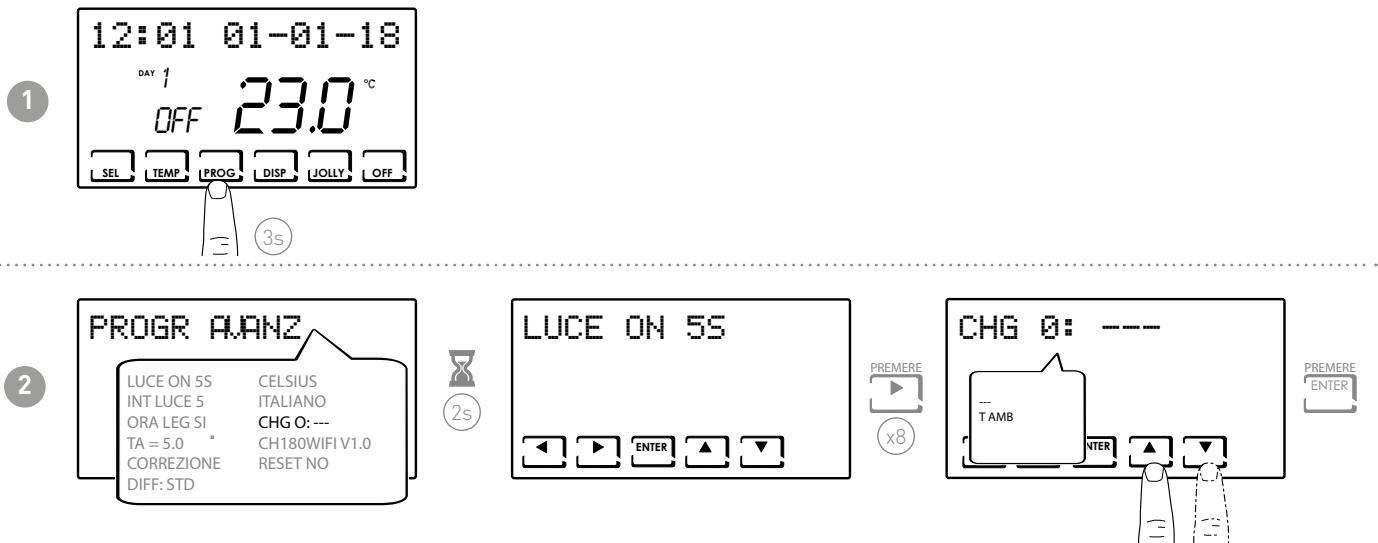

Note: when T AMB is selected, the PROG key is displayed. Then follow the procedure described in step 3.

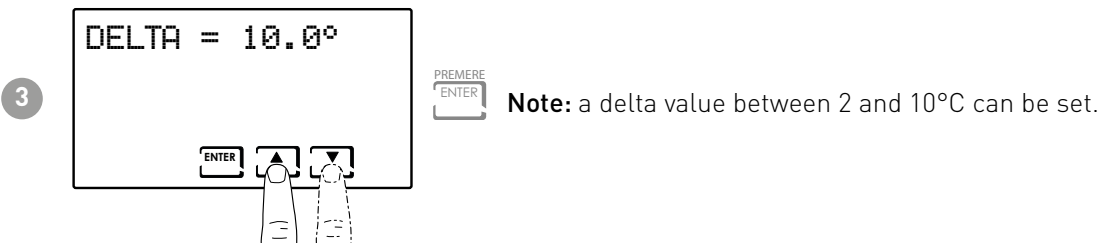

6.10 - TECHNICAL

Displays the software version of the programmable thermostat.

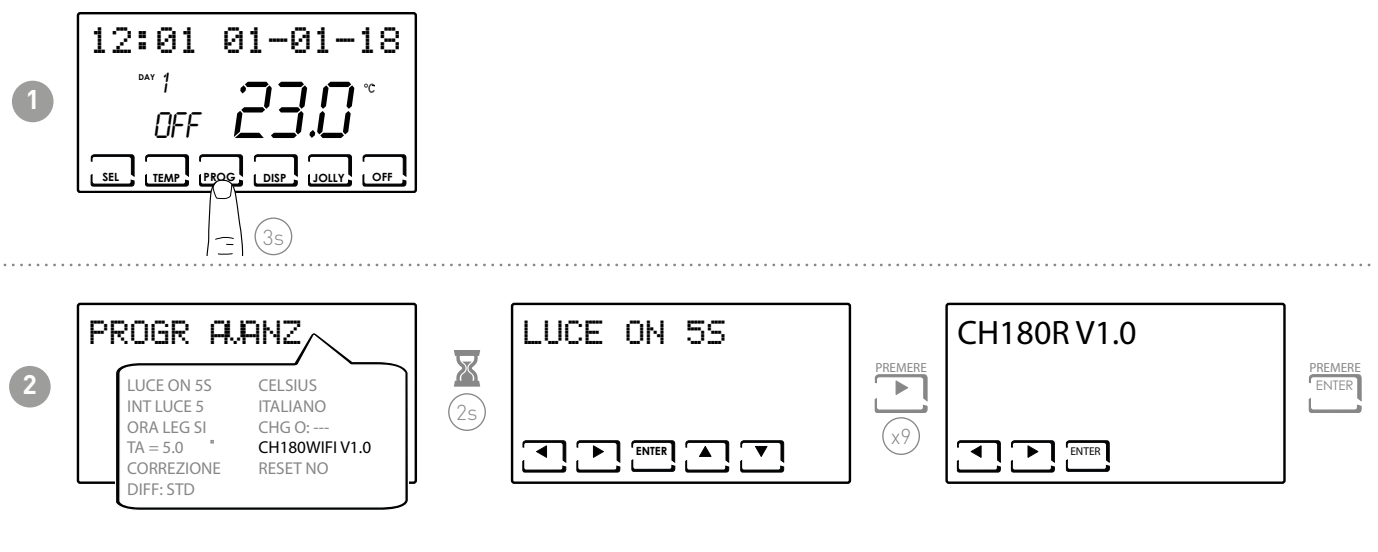

6.11 - RESETTING DEFAULT PARAMETERS

Allows you to reset all parameters (except the date and time) to the factory settings.

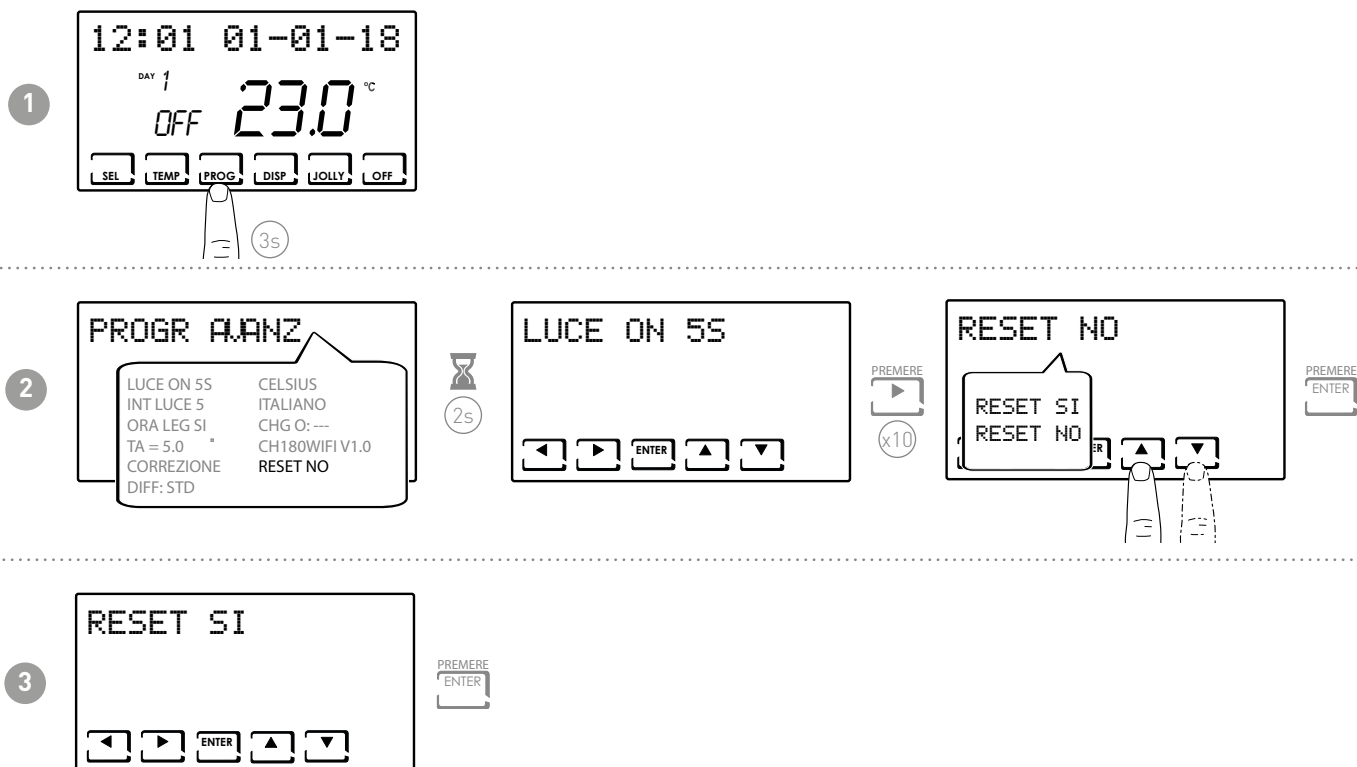

7 - DISPOSAL



The symbol of the crossed-out wheeled bin indicates that the products must be collected and disposed of separately from household waste. The batteries and integrated accumulators may be disposed of together with the product. They will be separated at the recycling facilities. A black bar indicates that the product was placed on the market after August 13th, 2005. Participating in the separate collection of products and batteries contributes to the correct disposal of these materials and therefore avoids possible negative consequences for the environment and human health. For more detailed information on the collection and recycling programmes available in your country, contact the local authorities or the sales point where you purchased the product.

8 - GENERAL WARRANTY CONDITIONS

The conventional warranty lasts 24 months, starting from the date the equipment is installed. The warranty covers all parts of the equipment, with the exception of those subjected to normal wear.

EAC CE

5680032 - 05/2022



Fantini Cosmi S.p.a. Via dell'Osio, 6 20049 Caleppio di Settala MI - ITALY
Tel. 02 956821 | Fax 02 95307006 | info@fantinicosmi.it | <http://www.fantinicosmi.it>
Technical support: supportotecnico@fantinicosmi.it
EXPORT DEPARTMENT Tel. ++39 02 95682222 | export@fantinicosmi.it