



070RL

ENG WIRELESS RADIATOR THERMOSTAT



FANTINI COSMI S.P.A.
Via Dell'osio, 6 - 20049 Caleppio di Settala (Mi) - ITALY
Email: info@fantinicosmi.it - www.fantinicosmi.it

TECHNICAL DATA

Attachment	M30x1.5
Radio band	EU868
RF power	< +14dbm
Radio modulation	LoRa
Firmware update	via radio (OTA)
Power supply	2 alkaline batteries 1.5V - LR6 - AA (do not use rechargeable batteries)
Autonomy	up to 24 months (dependent on mode of use)

Temperature display	Celsius (°C)
Temperature adjustment scale	2 ÷ 30 °C; increment 0.1 °C
Operating temperature	0 to 40°C
Storage temperature	-20 ÷ 65 °C
Relative storage humidity	20 ÷ 80% (90% without condensation)
Protection rating	IP30
Size	89.8 x Ø 54.2 mm
Directive 2014/30/EU (EMC); Directive 2014/35/EU (LVD); Directive 2014/53/EU (RED)	

Product not manufactured in Italy.



* when combined with CH180WIFIRL

Thank you for purchasing the Fantini Cosmi wireless radiator thermostat, model 070RL. This manual contains all the information required for a correct installation and use. You can also download this manual in digital format and in several languages by framing the QR code below and entering the product code.

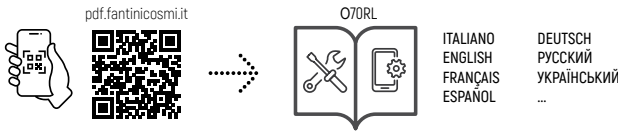

1 - DESCRIPTION

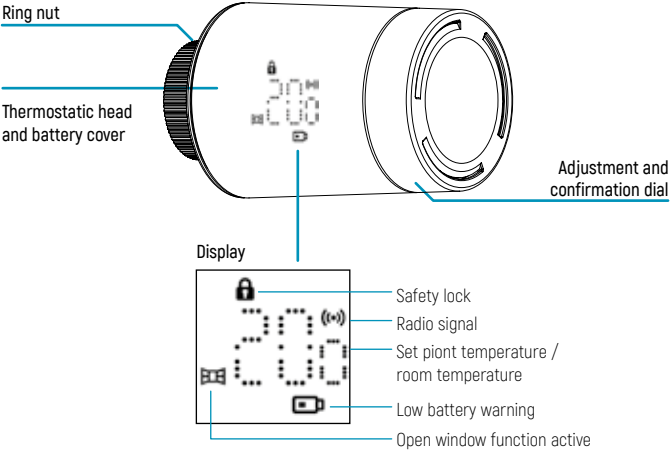

2 - INSTALLATION

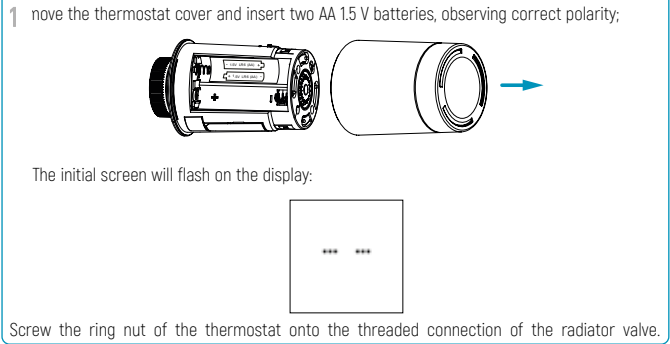

Screw the ring nut of the thermostat onto the threaded connection of the radiator valve.

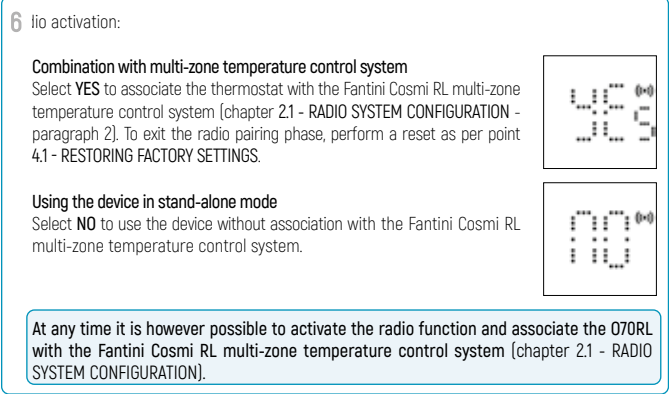
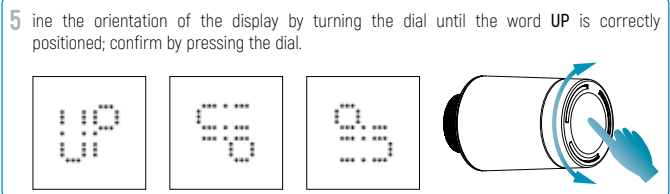
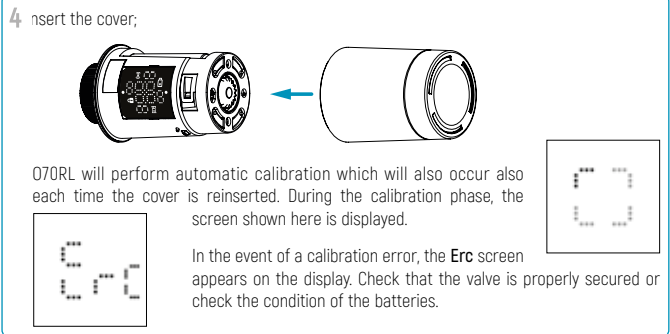
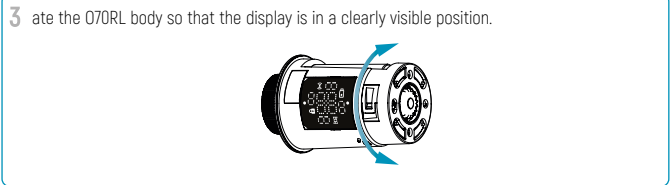
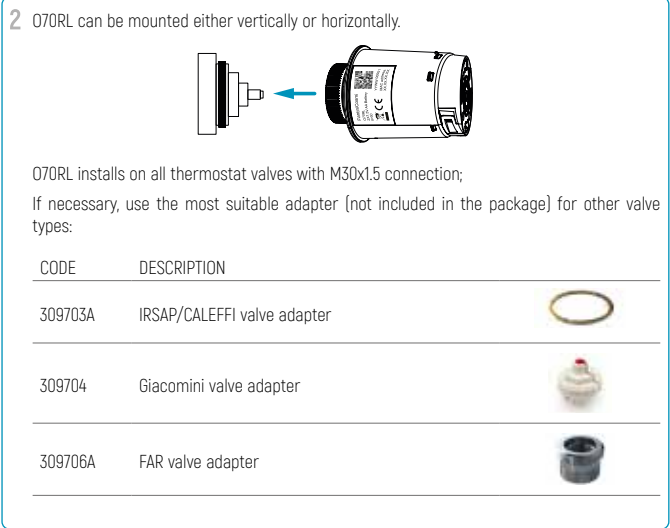

2.1 - RADIO SYSTEM CONFIGURATION (OPTIONAL)

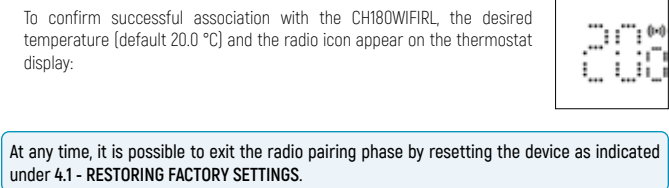
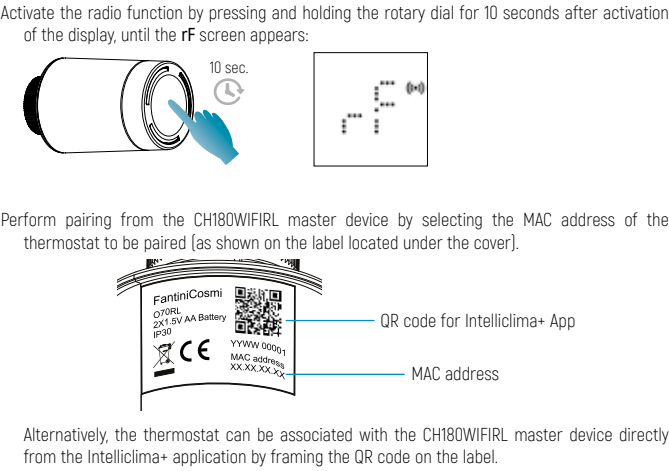

3 - USE

3.1 - SWITCHING ON THE DISPLAY AND TEMPERATURE DISPLAY

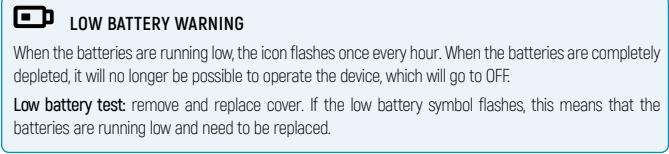
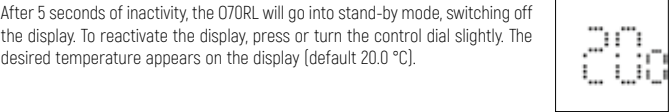

3.2 - SETTING THE TEMPERATURE

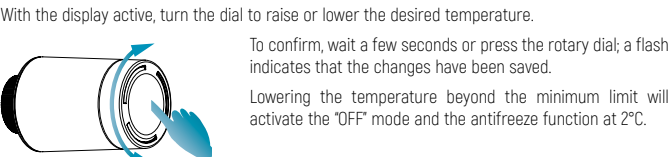

3.3 - SAFETY LOCK

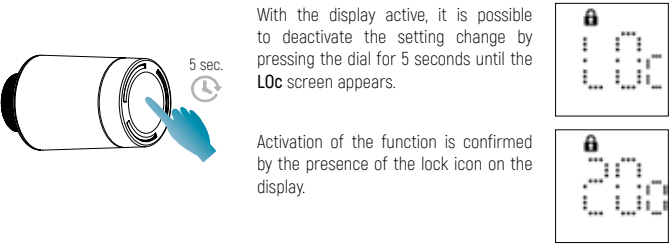

3.4 - OPEN WINDOW FUNCTION

When this function is enabled (see Chapter 4 - CHANGING SETTINGS), the device goes into OFF when an abrupt drop in the room temperature is detected, avoiding energy waste.

4 - CHANGING SETTINGS

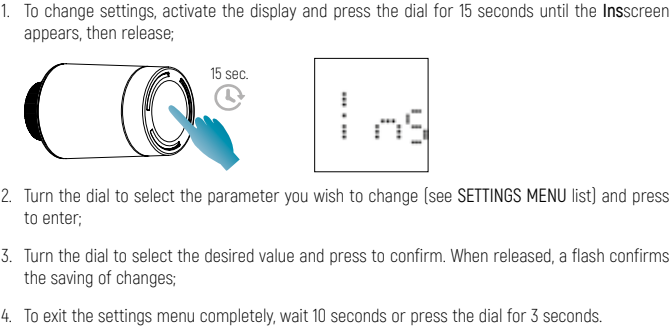

SETTINGS MENU

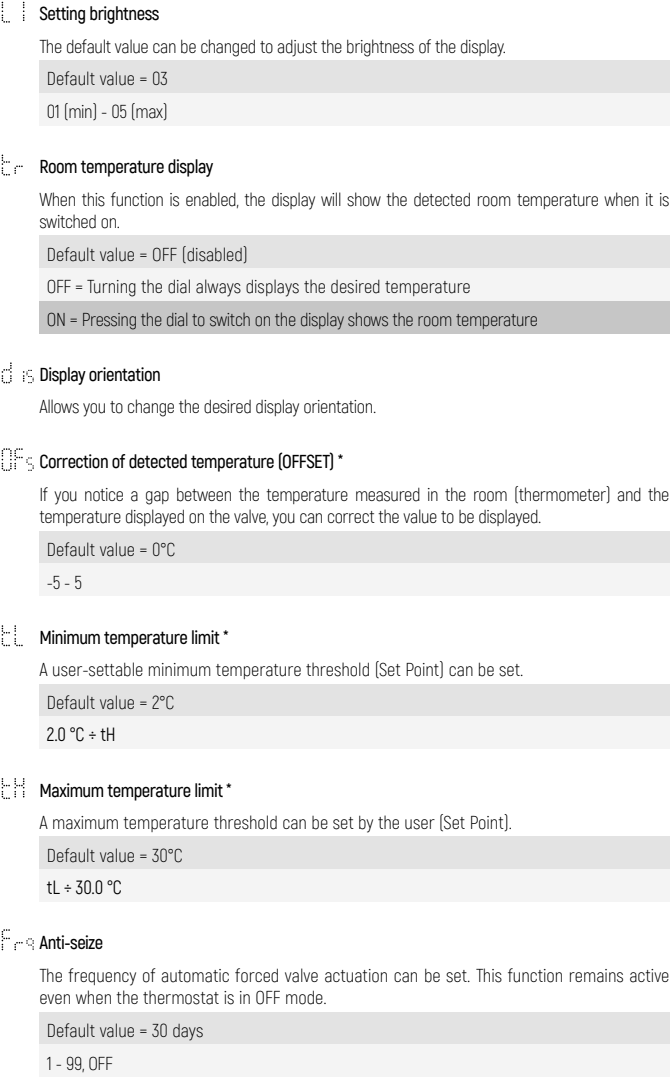

* Function only available for stand-alone use. If connected to the multi-zone system, the parameter will be managed by the CH180WIFIRL master device.

4.1 - RESTORING FACTORY SETTINGS

